

1

2

3

4

5

6

输出端Output

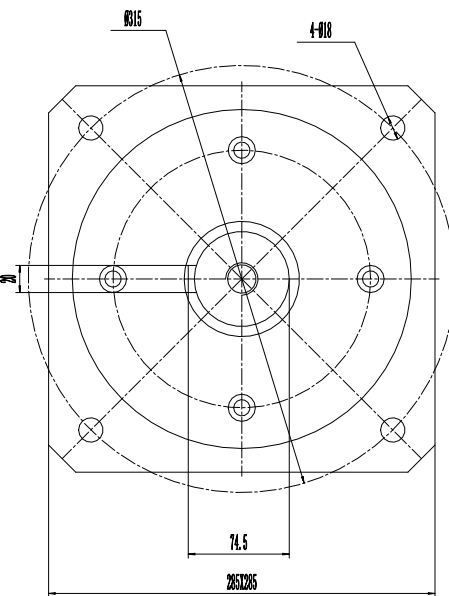

输入端Input

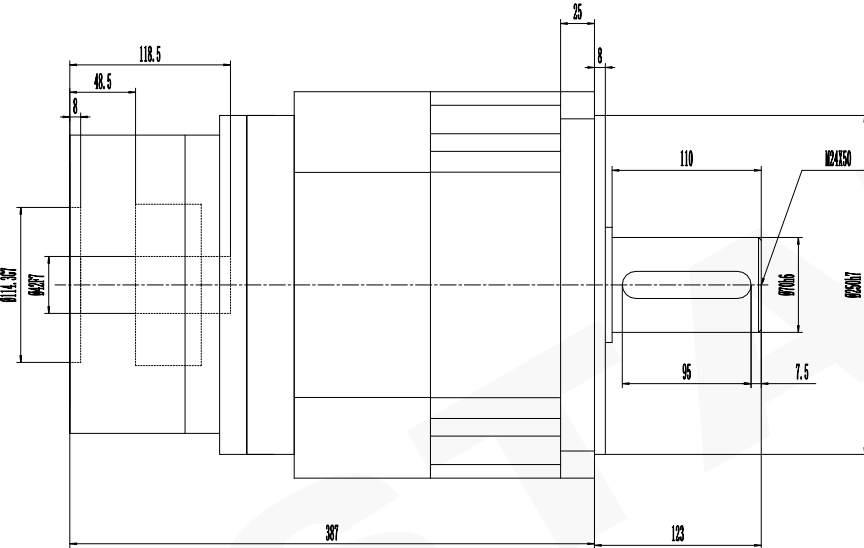
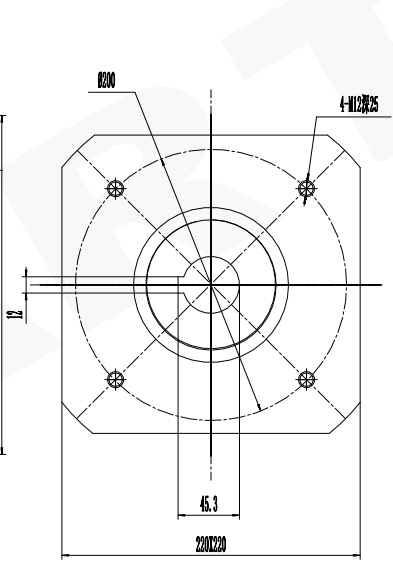

未注线性尺寸极限偏差
Unmarked tolerance

0.5-3	±0.2
3-6	±0.3
6-30	±0.5
30-120	±0.8
120-400	±1.2
400-1000	±2

减速比 (Ratio i)	12	15	16	25	32	35	40	30	50	64
额定承载扭矩 (Rated load torque) Nm	6998	4557	6998	4557	6998	4557	4557	4557	4557	2133
最大加速力矩 (Max. acceleration torque) Nm	12596	8203	12596	8203	12596	8203	8202.6	8202.6	8202.6	3839.4
急停扭矩 (Emergency stop torque) Nm	20994	13671	20994	13671	20994	13671	13671	13671	13671	6399

精密行星减速机技术参数

容许最大径向载荷 (Max. radial load)	45000N	空载力矩20℃ (No-load torque)	≤ 3Nm
容许最大轴向载荷 (Max. axial load)	53000N	润滑 (Lubrication)	合成润滑脂 (Synthetic grease)
额定输入转速 (Nominal input speed)	1000r/min	使用环境温度 (Operation temperature)	-15℃~+90℃
最大输入转速 (Max input speed)	2000r/min	使用寿命 (Service life)	≥20000h
噪音 (Noise) ≤	75db	防护等级 (Protection grade)	IP54
回程间隙 (Backlash)	18arcmin	PS系列	Tel/电话: 0533-6288333 6288444
		P2 L2	Fax/传真: 0533-6288411
			Web/网址: www.newstart.cn

精密行星减速机

Precision Planetary Gear Boxes



PS285L2-i-P2-S2
42-113-114.3-200-M12

A. PS. 285.

1

2

3

4

5

6